

1. Please detach the inner ring of the bird guard only if the diameter of the pole is more than 1.75".

O.D. of pole = 1.6"~1.75"

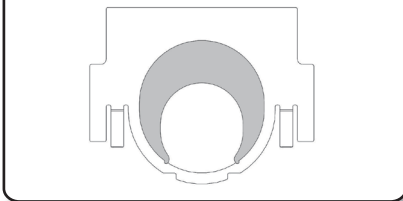

O.D. of pole = 1.75"~2.6"

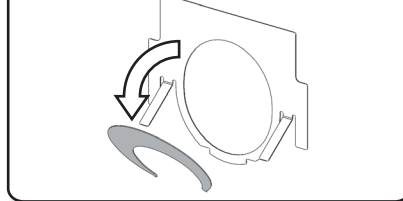

2. Release two clips on both sides of the luminaire to open the cover.

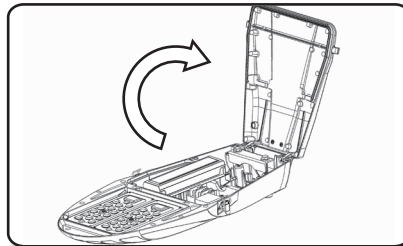
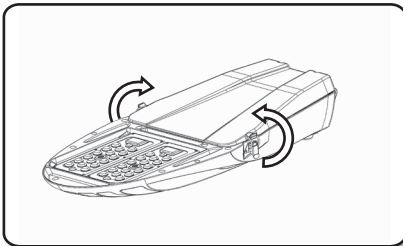

3. Slide the bird guard into position.

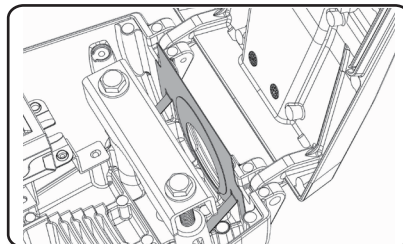
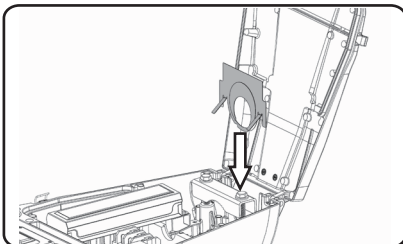

4. Install the luminaire to the pole facing upward or sideward.

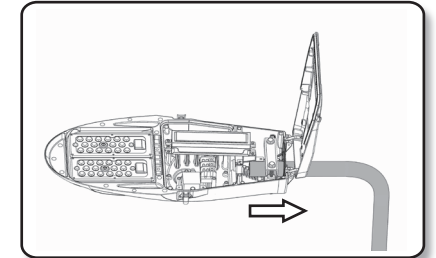
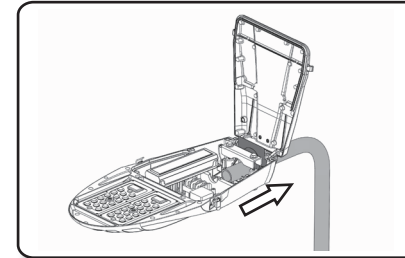

5. Rotate the luminaire to the desired position and angle.

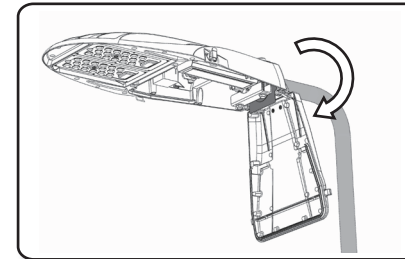

6. Screw the bolts of the luminaire tightly.

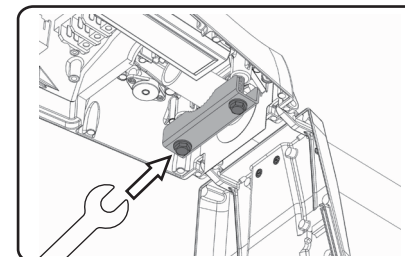

7. Follow the SL3 Installation Guide from steps 4~7 to complete wiring installation.